

Revised August 2014



02-024

4IN LED BAR

INSTALLATION INSTRUCTIONS

INCLUDED:

4in LED Bar
Bracket
Hardware Pack

TOOLS NEEDED: (NOT SUPPLIED)

02-027 Upgradable Harness

LED Bar



Bracket



Hardware Pack



Madjax recommends professional installation. If you choose to not have this product installed by a professional, we highly recommend that you exercise caution, care, and patience when installing this product.

IMPORTANT: Madjax® recommends the LED upgrade harness (02-027). Product sold separate.

Choose desired location on your cart to install the product. Mount bracket to desired location using hardware provided as shown.

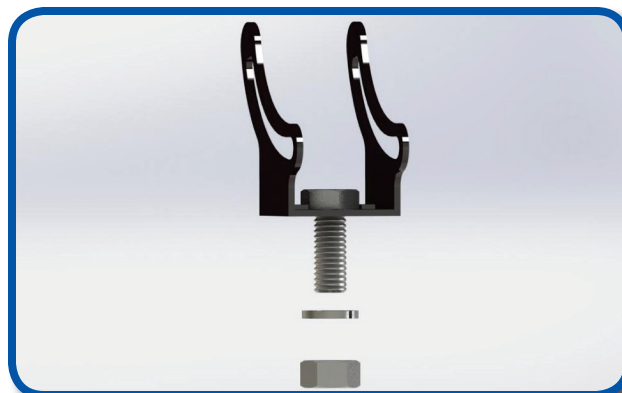

Once you have secured bracket to desired location, mount 4in LED bar to bracket using the hardware provided. Then attach appropriately to a 12 volt source.

Reducer may be required depending on cart configuration.